

# Miniature Thermocouple Connector Plug IM-R/S-M Type R/S IEC

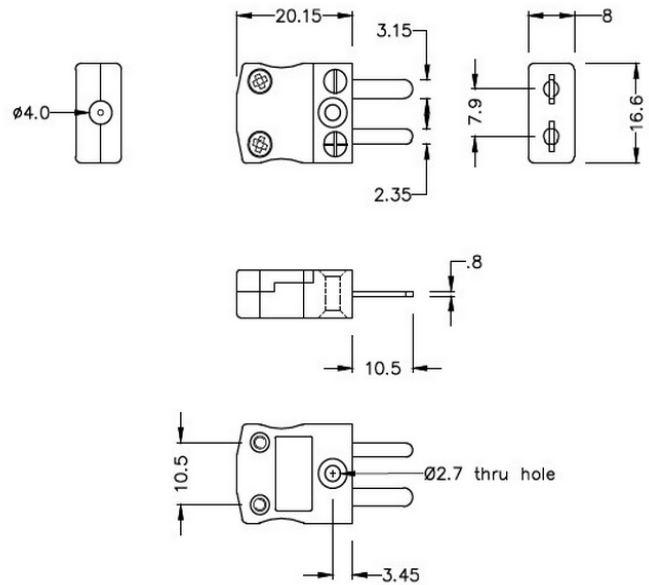

**Miniature in-line Plug**  
(dimensions in mm)

[Click here to view product](#)

<b>Product Code</b>	XE-1290-001
<b>General Description</b>	Ideal for general purpose use. Contacts are polarised to ensure correct connection.
<b>Thermocouple Type</b>	R/S IEC
<b>Connector Type</b>	Plug
<b>Connector Size</b>	Miniature
<b>Colour</b>	Orange
<b>Max. Temperature</b>	220°C
<b>Pins</b>	Flat Pins
<b>+Positive Contact</b>	Copper
<b>-Negative Contact</b>	Copper Alloy

Standards Met	BS EN 50212:1997. RoHS
---------------	------------------------

