

Miniature Thermocouple Connector Plug IM-E-M Type E IEC

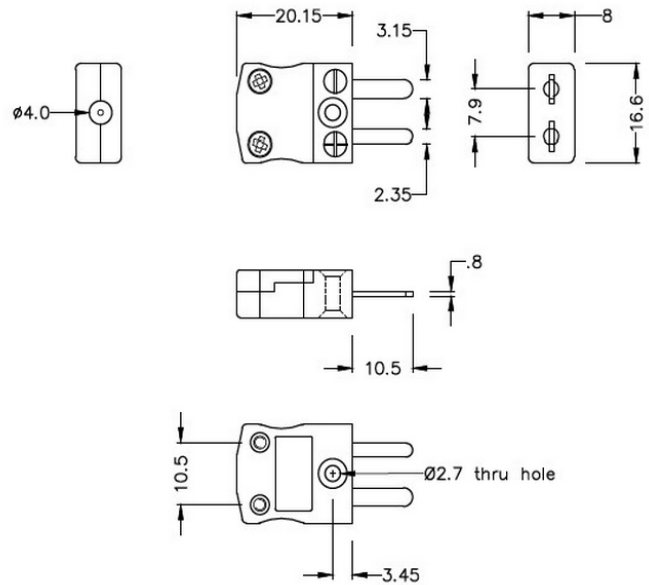

Miniature in-line Plug
(dimensions in mm)

[Click here to view product](#)

Product Code	XE-1330-001
General Description	Ideal for general purpose use. Contacts are polarised to ensure correct connection.
Thermocouple Type	E IEC
Connector Type	Plug
Connector Size	Miniature
Colour	Violet
Max. Temperature	220°C
Pins	Flat Pins
+Positive Contact	Nickel Chromium
-Negative Contact	Copper Nickel

Standards Met	BS EN 50212:1997. RoHS
---------------	------------------------

