

Miniature Quick Wire Connector Thermocouple Plug IM-B-MQ Type B IEC

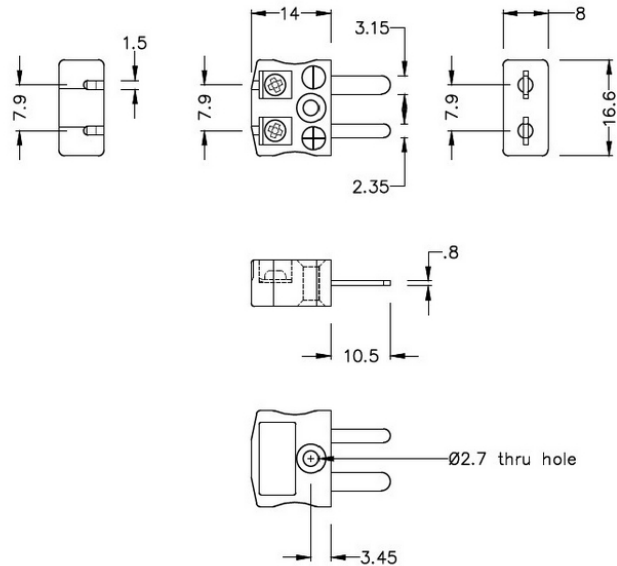

Miniature in-line Plug - Quick Wire
(dimensions in mm)

[Click here to view product](#)

Product Code	XE-1361-001
General Description	Easy jab-in connection for rapid termination.
Thermocouple Type	B IEC
Connector Type	Quick Wire Plug
Connector Size	Miniature
Colour	Grey
Dimensions	See Schematic Drawing (Product Literature Tab)
Max. Temperature	220°C
Pins	Flat Pins
+Positive Contact	Copper

-Negative Contact	Copper
Standards Met	BS EN 50212:1997. RoHS

