

# Miniature Thermocouple Connector Plug JM-E-M Type E JIS

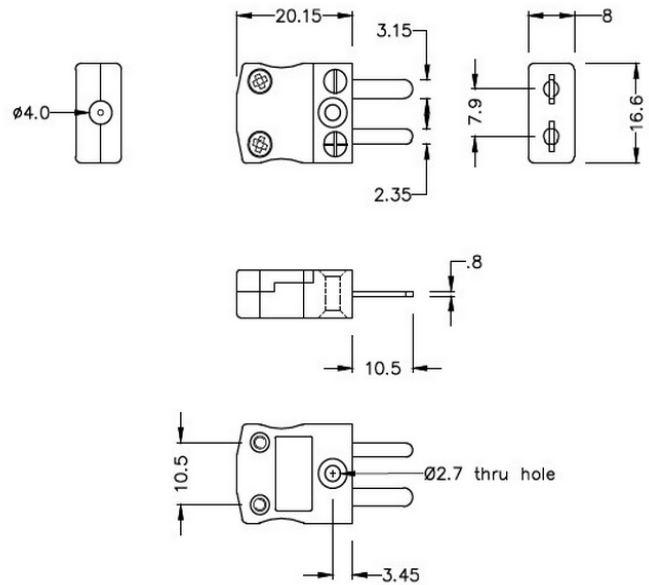
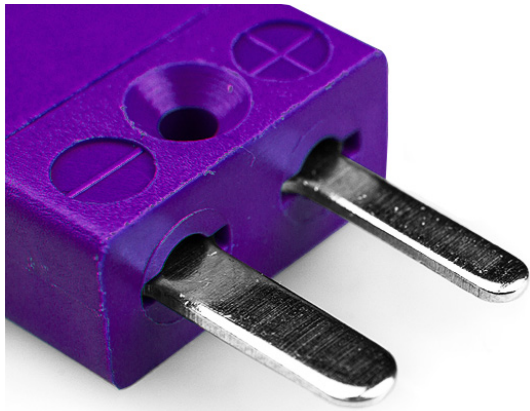

**Miniature in-line Plug**  
(dimensions in mm)

[Click here to view product](#)

<b>Product Code</b>	XE-9230-001
<b>General Description</b>	Ideal for general purpose use. Contacts are polarised to ensure correct connection.
<b>Thermocouple Type</b>	E JIS
<b>Connector Type</b>	Plug
<b>Connector Size</b>	Miniature
<b>Colour</b>	Violet
<b>Max. Temperature</b>	220°C
<b>Pins</b>	Flat Pins
<b>+Positive Contact</b>	Nickel Chromium
<b>-Negative Contact</b>	Copper Nickel

<b>Standards Met</b>	BS EN 50212:1997. RoHS
----------------------	------------------------

