

Standard Thermocouple Duplex Thermocouple Connector Plug JS-R/S-MD Type R/S JIS

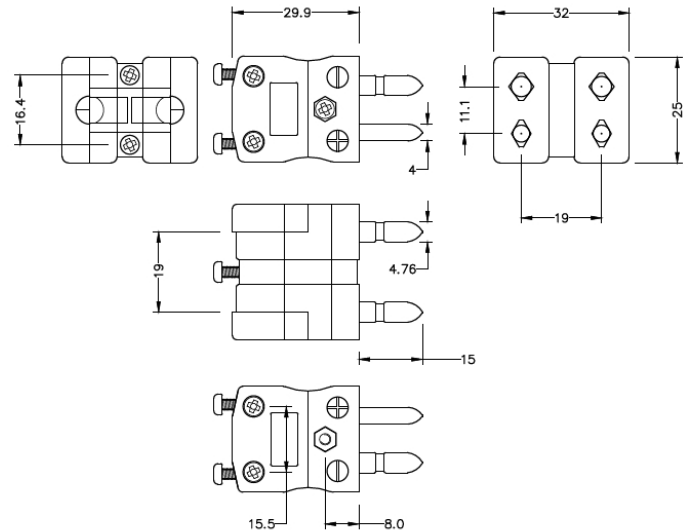

Standard Duplex in-line Plug
(dimensions in mm)

[Click here to view product](#)

Product Code	XE-9326-001
General Description	Rugged glass filled polyester bodies, suitable for industrial applications.
Thermocouple Type	R/S JIS
Connector Type	Duplex Plug
Connector Size	Standard
Colour	Black
Dimensions	See Schematic Drawing (Product Literature Tab)
Max. Temperature	220°C
Pins	Solid Round Pins
+Positive Contact	Copper

-Negative Contact	Copper Alloy
Standards Met	BS EN 50212:1997. RoHS

