

Standard Thermocouple Duplex Thermocouple Connector Plug JS-E-MD Type E JIS

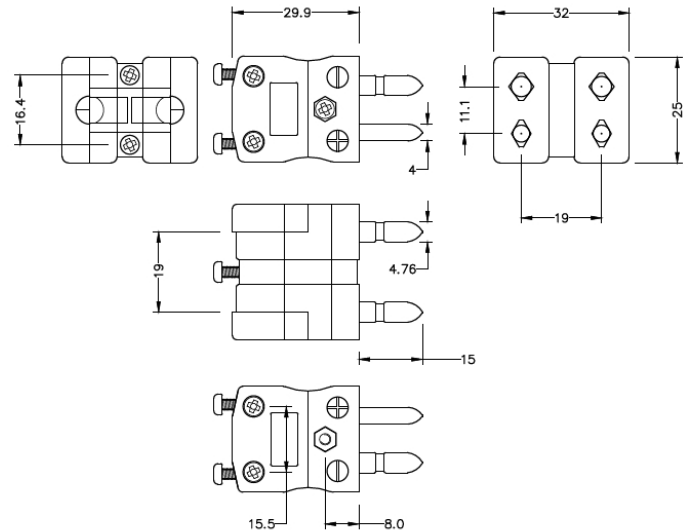

Standard Duplex in-line Plug
(dimensions in mm)

[Click here to view product](#)

Product Code	XE-9366-001
General Description	Rugged glass filled polyester bodies, suitable for industrial applications.
Thermocouple Type	E JIS
Connector Type	Duplex Plug
Connector Size	Standard
Colour	Violet
Dimensions	See Schematic Drawing (Product Literature Tab)
Max. Temperature	220°C
Pins	Solid Round Pins
+Positive Contact	Nickel Chromium

-Negative Contact	Copper Nickel
Standards Met	BS EN 50212:1997. RoHS

