

Standard Thermocouple Connector Duplex Socket JS-E-FD Type E JIS

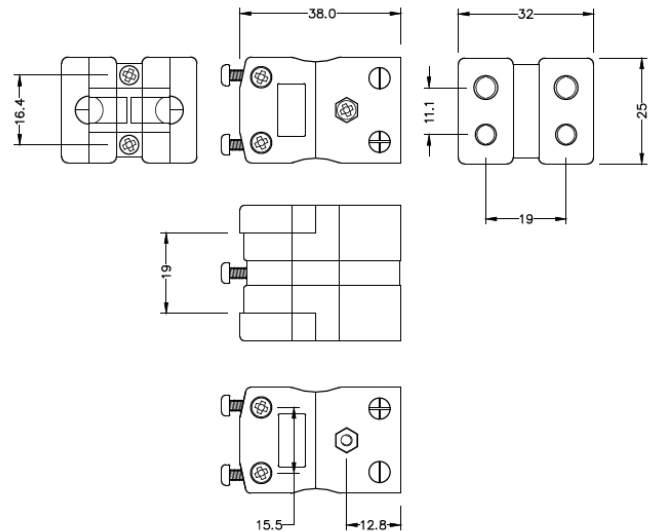

Standard Duplex in-line Socket
(dimensions in mm)

[Click here to view product](#)

Product Code	XE-9367-001
General Description	Plugs fitted with solid thermocouple pins. Rugged glass filled polyester bodies, suitable for industrial applications.
Thermocouple Type	E JIS
Connector Type	Duplex Socket
Connector Size	Standard
Colour	Violet
Dimensions	See Schematic Drawing (Product Literature Tab)
Max. Temperature	220°C
+Positive Contact	Nickel Chromium

-Negative Contact	Copper Nickel
Standards Met	BS EN 50212:1997. RoHS

